

## Fastener Categories

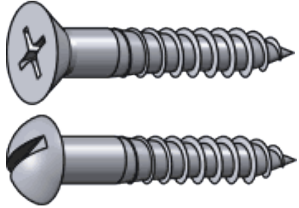

### Wood Screws

Screws with a smooth shank and tapered point for use in wood. Abbreviated WS.

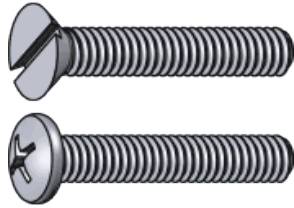

### Machine Screws

Screws with threads for use with a nut or tapped hole. Abbreviated MS.

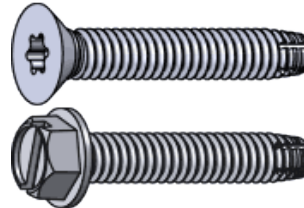

### Thread Cutting Machine Screws

Machine screws with a thread cutting (self tapping) point.

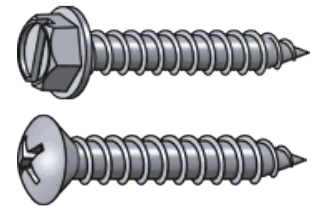

### Sheet Metal Screws

Fully threaded screws with a point for use in sheet metal. Abbreviated SMS.

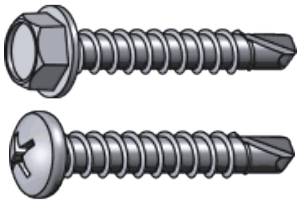

### Self Drilling SMS

A sheet metal screw with a self drilling point.

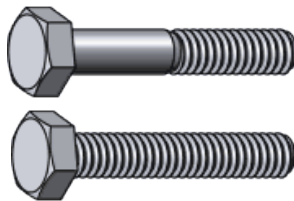

### Hex Bolts

Bolts with a hexagonal head with threads for use with a nut or tapped hole. Abbreviated HHMB or HXBT.

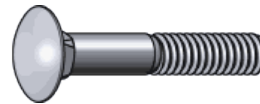

### Carriage Bolts

Bolts with a smooth rounded head that has a small square section underneath.

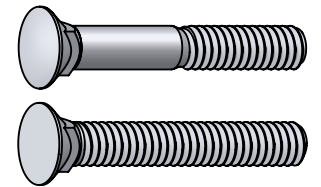

### Plow Bolts

Similar to carriage bolts but used for attaching the cutting edge of a plow to the plow blade.

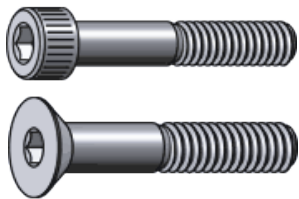

### Socket Screws

Socket screws, also known as Allen Head, are fastened with a hex Allen wrench.

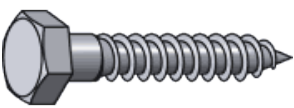

### Lag Bolts

Bolts with a wood thread and pointed tip. Abbreviated Lag.

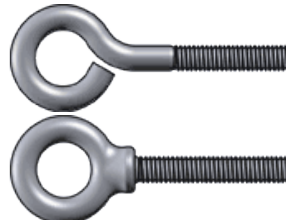

### Eye Bolts

A bolt with a circular ring on the head end. Used for attaching a rope or chain.



### Eye Lags

Similar to an eye bolt but with wood threads instead of machine thread.



### J-Bolts

J shaped bolts are used for tie-downs or as an open eye bolt.

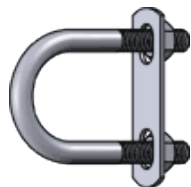

### U-Bolts

Bolts in U shape for attaching to pipe or other round surfaces. Also available with a square bend.



### Shoulder Bolts

Shoulder bolts (also known as stripper bolts) are used to create a pivot point.



### Elevator Bolts

Elevator bolts are often used in conveyor systems. They have a large, flat head.

## Fastener Categories (continued)

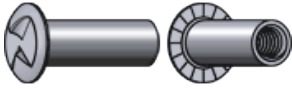

### Sex Bolts

Sex bolts (a.k.a. barrel nuts or Chicago bolts) have a female thread and are used for through bolting applications where a head is desired on both sides of the joint.

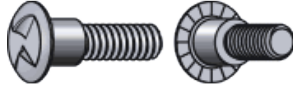

### Mating Screws

Mating screws have a shoulder that matches the diameter of the sex bolts they are used with.



### Hanger Bolts

Hanger bolts have wood thread on one end and machine thread on the other end.



### Set Screws

Machine screws with no head for screwing all the way into threaded holes.



### Timber Bolts

Machine threaded fasteners with a wide domed head. The head has fins underneath that prevent the bolt from spinning during installation. Typically used in wood.



### Cotter Pins

Cotter or split pins have two tines which are bent apart to hold them in place.



### Rivets

Used to join sheets of metal. During installation the rivet body is deformed to permanently lock in place. Blind rivets can be installed without access to the back side of the material.

## Head Styles

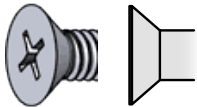

### Flat

A countersunk head with a flat top.  
Abbreviated FH

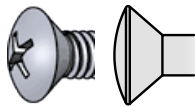

### Oval

A countersunk head with a rounded top.  
Abbreviated OH or OV

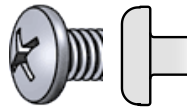

### Pan

A slightly rounded head with short vertical sides.  
Abbreviated PN

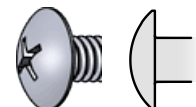

### Truss

An extra wide head with a rounded top.

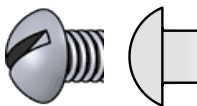

### Round

A domed head.  
Abbreviated RH

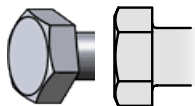

### Hex

A hexagonal head  
Abbreviated HH or HX

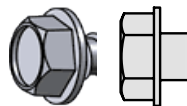

### Hex Washer

A hex head with built in washer.

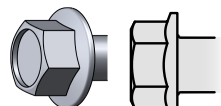

### Hex Flange

A hex head with built in flange.



### Slotted Hex Washer

A hex head with built in washer and a slot.

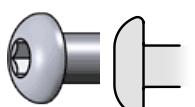

### Button

A low-profile rounded head using a socket drive.

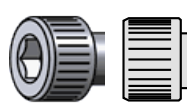

### Socket Cap

A small cylindrical head using a socket drive.

## Drive Types

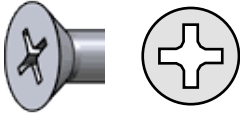

### Phillips and Frearson

An X-shaped drive.  
Abbreviated PH.

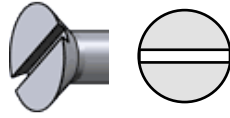

### Slotted

A slot in the head.  
Abbreviated SL.

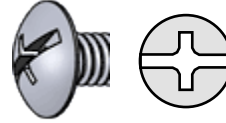

### Combination

A combination of slotted and  
Phillips drives.  
Abbreviated combo.

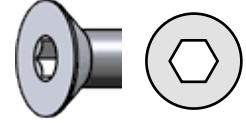

### Socket, Hex or Allen

A hexagonal hole for use  
with an Allen wrench.

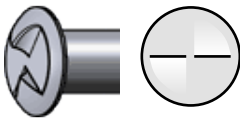

### One Way

Installs with a normal slotted  
driver but can not be  
removed without special  
tools.

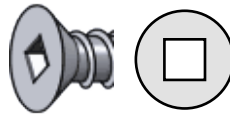

### Square

Also known as Robertson  
drive.  
Abbreviated SQ or SD.

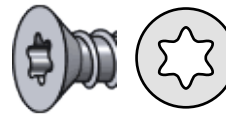

### Star

A six-pointed star pattern,  
specifically designed to  
prevent cam-out and stripped  
heads.

## Washer Types

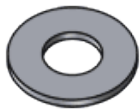

### Flat

A flat washer, used to  
distribute load. Available in  
SAE, USS and other patterns.

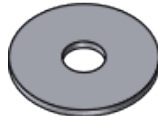

### Fender

An oversize flat washer used  
to further distribute load  
especially on soft materials.



### Finishing

A washer used to obtain a  
'finished' look. Usually used  
with oval head screws.



### Split Lock

The most common style of  
washer used to prevent nuts  
and bolts from backing out.



### External Tooth Lock

A washer with external  
'teeth'. Used to prevent nuts  
and bolts from backing out.



### Internal Tooth Lock

A washer with internal 'teeth'.  
Used to prevent nuts and  
bolts from backing out.

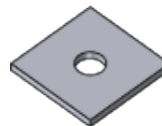

### Square

A square shaped washer.

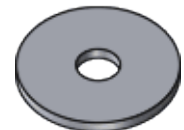

### Dock

Dock washers have a larger  
outside diameter and are  
thicker than standard.



### Ogee

Thick, large diameter, cast  
iron washers with a curved or  
sculpted appearance.  
Typically used in dock and  
wood construction.

## Nut Types

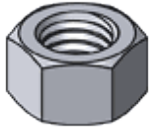

### Hex

A six sided nut. Also referred to as a Finished Hex Nut.

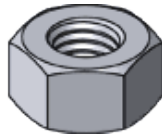

### Heavy Hex

A heavier pattern version of a standard hex nut.

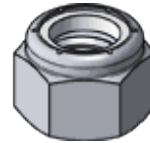

### Nylon Insert Lock

A nut with a nylon insert to prevent backing off. Also referred to as a Nylock.

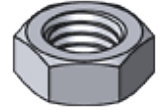

### Jam

A hex nut with a reduced height.

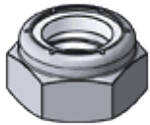

### Nylon Insert Jam Lock

A nylock nut with a reduced height.



### Wing

A nut with 'wings' for hand tightening.

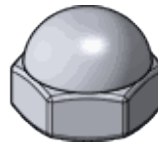

### Cap

A nut with a domed top over the end of the fastener.



### Acorn

Acorn nuts are a high crown type of cap nut, used for appearance.

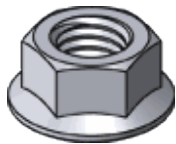

### Flange

A nut with a built in washer like flange.

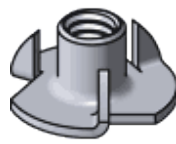

### Tee

A nut designed to be driven into wood to create a threaded hole.

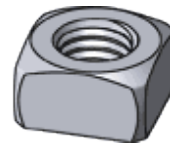

### Square

A four sided nut.

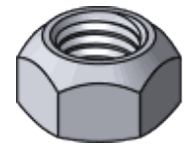

### Prevailing Torque Lock

A non-reversible lock nut used for high temperature applications.

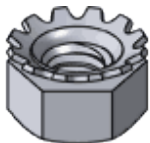

### K-Lock or Kep

A nut with an attached free-spinning external tooth lock washer.



### Coupling

Coupling nuts are long nuts used to connect pieces of threaded rod or other male fasteners.

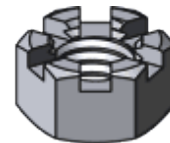

### Slotted

Slotted nuts are used in conjunction with a cotter pin on drilled shank fasteners to prevent loosening.

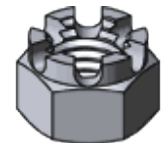

### Castle

Castle nuts are used in conjunction with a cotter pin on drilled shank fasteners to prevent loosening.

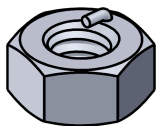

### Pin Lock

A nut that does not require an high installation torque and can be installed and removed without thread damage.

## Anchoring Products



### Stud Anchors

A.k.a. Wedge Anchors. One piece expansion bolts for heavy duty fastening into stone or solid concrete.

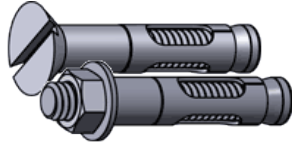

### Sleeve Anchors

Heavy duty masonry anchors. Does not require a solid base material for installation.

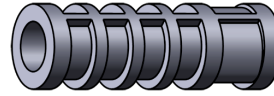

### Lag Shields

Medium duty anchors for use in concrete, brick or mortar. Use with a lag bolt.

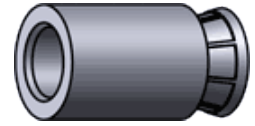

### Machine Screw Anchors

A two-piece machine thread anchor for use in stone, brick, or concrete.



### Drop-in Anchors

A heavy duty machine thread anchor for concrete or stone.

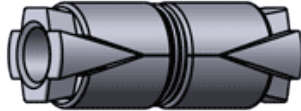

### Double Expansion Sleeves

Expansion anchor for masonry that ensures contact along the length of the hole.

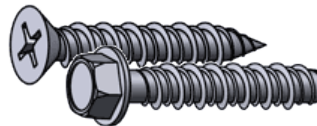

### Concrete Screws

Used in concrete, brick or block. A quick and easy way to fasten in light to medium duty applications

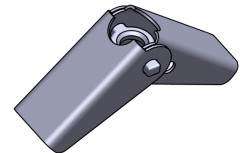

### Spring Toggle Wings

Non-removable fasteners that expand behind the material, e.g. inside a wall, for a secure grip.



### Plastic Toggle

When these anchors are driven in they expand inside the hole for a secure grip. Drill hole the same size as the anchor. Non-removable.

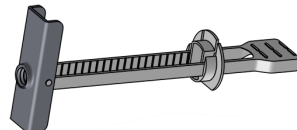

### Kaptoggle®

A non removable anchor commonly used for hollow spaces such as drywall and masonry block.

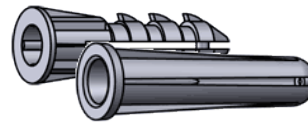

### Conical Anchors

Plastic anchors used with sheet metal screws. Can be used in most materials.



### Self Drilling Drywall Anchors

Quick-install plastic anchors used in drywall with sheet metal screws.



### Wood Screw Anchors

This anchor is made of lead and can be used with wood screws or sheet metal screws.

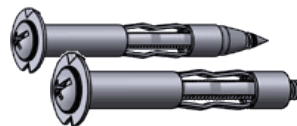

### Hollow Wall Anchors

A.k.a. Molly Bolts. Used for light duty anchoring in drywall or other hollow walls.

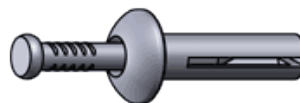

### Nail Drive Anchors

Non removable anchors that expand inside the hole when the nail like pin is driven.



### Anchor Bolts

L shaped, machine threaded anchors. Typically embedded in concrete when it is poured.